

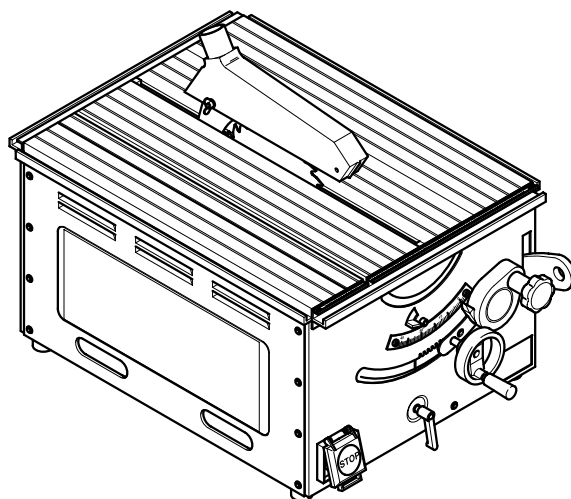

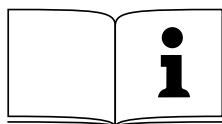



ELEKTRA BECKUM

Ein Unternehmen der Metabo-Gruppe



PK 200



 Betriebsanleitung	3
 Operating Instruction	12
 Instructions d'utilisation	21
 Manuale d'istruzioni	30
 Manual de uso	39

D DEUTSCH**KONFORMITÄTSERKLÄRUNG**

Wir erklären in alleiniger Verantwortlichkeit, daß dieses Produkt mit den folgenden Normen übereinstimmt* gemäß den Bestimmungen der Richtlinien**

EG-Baumusterprüfung *** durchgeführt von ****

F FRANÇAIS**DECLARATION DE CONFORMITE**

Nous déclarons, sous notre seule responsabilité, que ce produit est en conformité avec les normes ou documents normatifs suivants* en vertu des dispositions des directives**

Contrôle européen du modèle type *** effectué par ****

IT ITALIANO**DICHIARAZIONE DI CONFORMITÀ**

Noi dichiariamo sotto la nostra esclusiva responsabilità che il presente prodotto è conforme alle seguenti norme* in conformità con le disposizioni delle normative** Omologazione CE *** eseguita da ****

PT PORTUGUÊS**DECLARAÇÃO DE CONFORMIDADE**

Declaramos sob nossa responsabilidade que este produto está de acordo com as seguintes normas* de acordo com as directrizes dos regulamentos** controle de amostra de Construção da CE *** efectuado por ****

FIN SUOMI**VAATIMUKSEN MUKAISUUSVAKUUTUS**

Vakuutamme, että tämä tuote vastaa seuraavia normeja* on direktiivien määräysten mukainen**

EY-tyyppitarkastustesti *** testin suorittaja: ****

DA DANSK**OVERENSSTEMMELSEATTEST**

Hermed erklærer vi på eget ansvar, at dette produkt stemmer overens ed følgende standarder* iht bestemmelserne i direktiverne** EF-typekontrol *** gennemført af ****

EL ΕΛΛΗΝΙΚΑ**ΔΗΛΩΣΗ ΑΝΤΙΣΤΟΙΧΙΑΣ**

Δηλώνουμε με ίδια ευθύνη ότι το προϊόν αυτό αντιστοιχεί στις ακόλουθες προδιαγραφές*

σύμφωνα με τις διατάξεις των οδηγιών**

Έλεγχος-ΕΟΚ δομικού πρωτοτύπου*** πραγματοποιούμενος από το****

ENG ENGLISH**DECLARATION OF CONFORMITY**

We herewith declare in our sole responsibility that this product complies with the following standards*

in accordance with the regulations of the undermentioned Directives** EC type examination *** conducted by ****

NL NEDERLANDS**CONFORMITEITSVERKLARING**

Wij verklaren als enige verantwoordelijke, dat dit product in overeenstemming is met de volgende normen*

conform de bepalingen van de richtlijnen** EG-typeonderzoek *** uitgevoerd door ****

ES ESPAÑOL**DECLARACION DE CONFORMIDAD**

Declaramos bajo nuestra exclusiva responsabilidad, que el presente producto cumple con las siguientes normas* de acuerdo a lo dispuesto en las directrices** Homologación de tipo CE *** llevada a cabo por ****

SV SVENSKA**FÖRSÄKRAN OM ÖVERENSSTÄMMELE**

Vi försäkrar på eget ansvar att denna produkt överensstämmer med följande standarder* enligt bestämmelserna i direktiven**

EG-materialprovning *** genomförd av ****

NO NORGE**SAMSVARSERKLÆRING**

Vi erklærer under eget ansvar at dette produkt samsvarer med følgende normer* henhold til bestemmelsene i direktiv**

EU-typegodkjennelse *** utstilt av ****

POL POLSKI**OŚWIADCZENIE O ZGODNOŚCI**

Oświadczamy z pełną odpowiedzialnością, że niniejszy produkt odpowiada wymogom następujących norm* według ustaleń wytycznych** Kontrola wzorców UE *** przeprowadzone przez ****

HU MAGYAR**MEGEGYZŐSÉGI NYILATKOZAT**

Kizárólagos felelősségünk tudatában ezennel igazoljuk, hogy ez a termék kielégíti az alábbi szabványokban lefektetett követelményeket* megfelel az alábbi irányelvek előírásainak**

által végzett vizsgálat szerint megegyezik az alábbi építési mintapéldánnyal *** a ****

PK 200

* EN 61029-1, DIN EN 294

** 98/37/EG, 73/23 EWG, 89/336/EWG

*** BG 9511244-01

**** TÜV Rheinland, Am Grauen Stein

D-51105 Köln

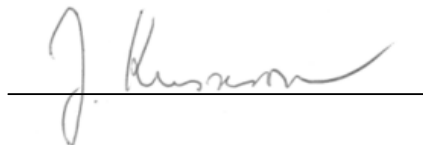

Jürgen Kusserow

Vorstand



ELEKTRA BECKUM AG – Daimlerstraße 1 – 49716 Meppen

1000924/00

1. Getting to Know Your Saw

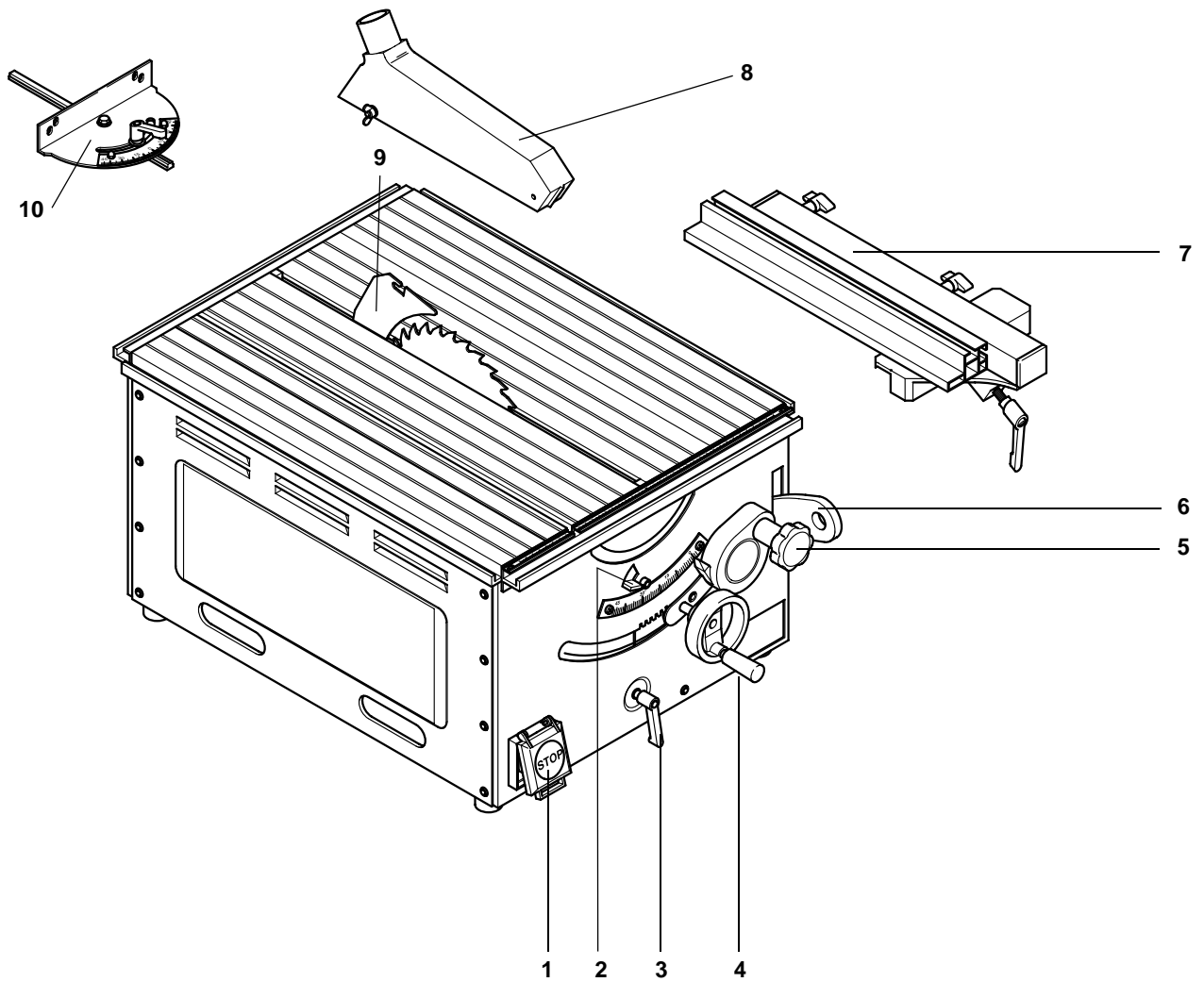

- 1 ON/OFF switch with emergency stop
- 2 Lever, blade tilt limiter
- 3 Ratchet lock lever to lock saw blade tilt
- 4 Handwheel for setting the depth of cut
- 5 Handwheel for blade tilt setting

- 6 Push stick / feeding aid
- 7 Rip fence
- 8 Blade guard
- 9 Riving knife
- 10 Mitre fence
- 11 Chip ejection tube

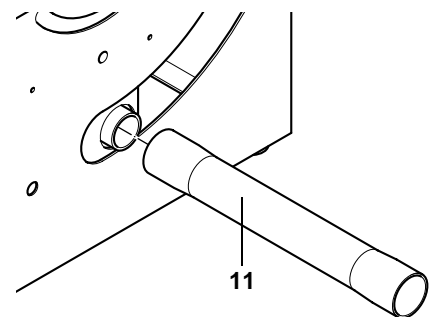

Table of Contents

1. Getting to Know Your Saw.....	12
2. Please Read First!.....	13
3. Safety.....	13
3.1 Specified conditions of use.....	13
3.2 General safety instructions.....	13
3.3 Symbols shown on the circular saw.....	14
3.4 Symbols used throughout these instructions.....	14
3.5 Safety devices.....	14
4. Special Product Features.....	14
5. Transportation.....	14
6. Operating Elements.....	15
7. Initial Operation.....	15
7.1 Installation.....	15
7.2 Riving knife alignment and blade guard installation.....	16
7.3 Connection of dust collector.....	16
7.4 Mains connection.....	16
8. Operation.....	16
8.1 Sawing.....	17
9. Care and Maintenance.....	17
9.1 Saw blade change.....	17
9.2 Scale setting.....	18
9.3 Mitre fence adjustment.....	18
9.4 Blade tilt stop setting.....	18
9.5 Saw cleaning.....	18
9.6 Machine storage.....	18
9.7 Maintenance.....	18
10. Tips and Tricks.....	18
11. Available Accessories.....	18
12. Repairs.....	19
13. Environmental Protection.....	19
14. Trouble Shooting.....	19
15. Technical Specifications.....	20
16. Available Accessories.....	50

2. Please Read First!

- Read these instructions before use. Pay special attention to the safety instructions.
- If you notice transport damage while unpacking, notify your supplier immediately. **Do not** operate the saw!
- Dispose of the packing in an environmentally friendly manner. Take to a proper collecting point.
- Keep these instructions for reference on any issues you may be uncertain about.
- If you lend or sell this machine be sure to have the instructions go with it.

3. Safety

3.1 Specified conditions of use

This machine is intended to rip and crosscut grown timber, faced boards, chip board and wood-core plywood sheets, and similar wood-derived materials.

Metals can only be cut with the following restrictions:

- with suitable saw blade only (see "Available Accessories")
- non-ferrous metals only (no hard or hardened metals)

Do not cut round stock without suitable jigs or fixtures. The rotating saw blade could turn the workpiece.

When sawing thin stock layed on edge, a suitable guide must be used for firm support.

Use of wobble saw blades is not permitted on this machine.



Danger!
Any other use is not as specified.

Use not as specified, alteration of the electric tool or use of parts that are not approved by the equipment manufacturer can cause unforeseeable damage!

3.2 General safety instructions

When operating this electric tool observe the following safety instructions, to exclude the risk of personal injury or material damage.

Please also observe the special safety instructions in the respective chapters; Keep all enclosed documents for future reference.

Observe the statutory accident insurance institution regulations and regulations for the prevention of accidents pertaining to the operation of circular saws, where applicable.



General Hazard!

Keep your work area tidy – a messy work area invites accidents.

Be alert. Know what you are doing. Set out to work with reason. Do not operate electric tool while under the influence of drugs, alcohol or medication.

Consider environmental conditions.

Keep work area well lighted.

Prevent adverse body positions. Ensure firm footing and keep your balance at all times. Use suitable workpiece supports when cutting long stock.

Do not operate electric tool near inflammable liquids or gases.

The circular saw shall only be started and operated by persons familiar with circular saws, and who are at any time

aware of the dangers associated with the operation of such tool.

Persons under the age of 18 years shall operate this electric tool only in the course of their vocational training, under the supervision of an instructor.

Keep bystanders, particularly children, out of the danger zone. Do not permit other persons to touch the electric tool or power cable while it is running.

Do not overload electric tool – use it only within the performance range it was designed (see "Technical Specifications").



Danger! Risk of electric shock!

Do not expose electric tool to rain.

Do not operate electric tool in damp or wet environment.

Prevent body contact with earthed objects such as radiators, pipes, cooking stoves, refrigerators when operating this electric tool.

Do not use the power cable for purposes it is not intended for.



Risk of personal injury and crushing by moving parts!

Do not operate the electric tool without installed guards.

Always keep sufficient distance to the cutting tool. Use suitable feeding aids, if necessary.

Keep sufficient distance to motor and driven components when operating electric tool. Ensure electric tool is disconnected from power supply before servicing.

Ensure that when switching on (e.g. after servicing) no tools or loose parts are left on or in the electric tool.

Turn power off if the electric tool is not used.



Cutting hazard, even with the cutting tool at standstill!

Wear gloves when changing cutting tools.



Risk of kickback (workpiece is caught by the saw blade and thrown against the operator)!

Always work with a properly set riving knife.

Do not jam workpieces.

Cut thin or thin-walled workpieces only with fine-toothed saw blades. Always use sharp saw blades.

If in doubt, check workpiece for inclusion of foreign matter (e.g. nails or screws).



Drawing-in/trapping hazard!

Ensure that no parts of the body or clothing can get caught and drawn in by rotating components (**no** neckties, **no** loose-fitting clothes; contain long hair with hair-net).

Hazard generated by insufficient personal protection gear!

Wear hearing protection.
Wear safety glasses.
Wear dust mask if work generates dust.
Wear suitable work clothes. When working outdoors wearing of non-slip shoes is recommended.

Risk of injury by inhaling wood dust!

Dust of certain timber species (e.g. beech, oak, ash) can cause cancer when inhaled: use a suitable dust collector (see "Technical Specifications").

Hazard generated by electric tool defects!

Keep electric tool and accessories in good repair. Observe the maintenance instructions.

Check electric tool for possible damage before any use: before operating the electric tool all safety devices, protection devices or slightly damaged parts must be inspected for proper functioning as specified. Check to see that all moving parts work properly and do not jam. All parts must be correctly installed and meet all conditions necessary for the proper operation of the electric tool.

Damaged protection devices or parts must be repaired or replaced by an qualified specialist. Have damaged switches replaced by a service centre. Do not operate electric tool if the switch can not be turned ON or OFF. Keep handles free of oil and grease.

3.3 Symbols shown on the circular saw

Danger! Disregard of the following warnings can lead to severe personal injury or material damage.

- Read instructions.
- Do not reach into the revolving saw blade.
- Wear hearing protection.

Use push stick if distance between saw blade and rip fence is ≤ 120 mm.

Cut round stock only with a suitable holding device.



Use table extension, if otherwise workpiece would fall off the table after cutting.

3.4 Symbols used throughout these instructions

Danger! Indicates risk of personal injury or severe material damage.

Risk of electric shock! Risk of personal injury by electric shock.

Drawing-in/trapping hazard! Risk of personal injury by body parts or clothing being drawn into the rotating saw blade.

Caution! Risk of material damage

Note: Supplementary information

3.5 Safety devices

Blade guard

The blade guard (12) protects against unintentional contact with the saw blade and from chips flying about.

Always have blade guard installed during operation.

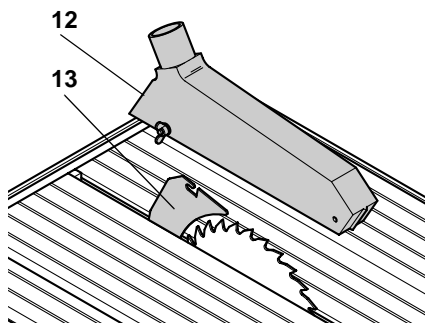

Riving knife

The riving knife (13) prevents the workpiece from being caught by the rising teeth of the saw blade and being thrown against the operator.

Always have riving knife installed during operation.

Push stick

The push stick (14) serves as an extension of the hand and protects against accidental contact with the saw blade.

Use push stick if distance rip fence – saw blade is ≤ 120 mm.

In order for the push stick to be always at hand, it can be stored in a sheath inside the machine's housing.

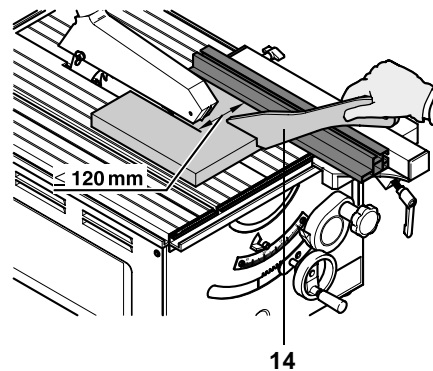

4. Special Product Features

- Precisely adjustable bevel tilt from – 1.5° through 46.5°.
- Steplessly adjustable depth of cut 0 – 65 mm.
- All operating elements are located at the machine's front.
- Electronic speed control:
 - motor soft start;
 - low mains supply load;
 - constant saw blade speed irrespective of load provides for consistent cut quality;
 - extended service life of the carbon brushes;
 - low no-load speed results in less annoyance by noise.
- An electronic motor protection by overcurrent detection shuts the motor off when it is locked (e.g. by a blocked saw blade).
- An undervoltage relay prevents the machine from starting up when power is restored after a power failure.
- Compact design for quick and easy transportation.
- Mitre fence and rip fence are standard delivery.

5. Transportation

- Lower saw blade fully.
- Dismount add-on parts (fence, sliding carriage, table extension).
- If possible use original carton for shipping.

Caution! For carrying use the handle holes at the sides of the machine. Do not carry the machine holding it by any of the safety devices or operating elements!

6. Operating Elements

ON/OFF switch with emergency stop

- To switch ON = depress upper button (15).
- To switch OFF = push lower button (16) or on switch cover.

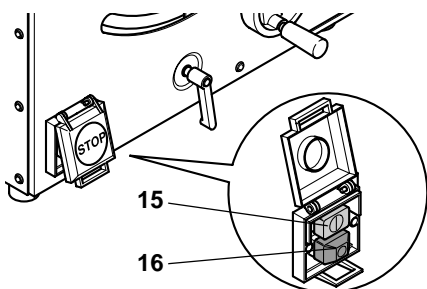

i Note:

Upon power failure an undervoltage relay is activated. This prevents the starting of the machine when the power is restored. To restart the saw after a power failure the green switch button (15) needs to be actuated again.

The ON/OFF switch can be blocked by a padlock.

Handwheel for setting the depth of cut

The depth of cut can be adjusted by turning the handwheel (17).

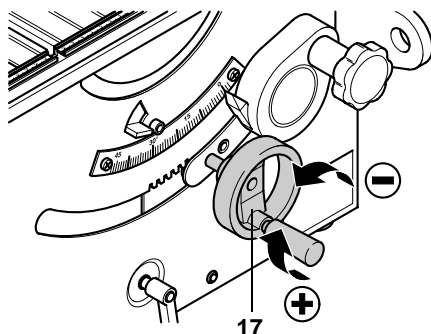

Handwheel for blade tilt setting

With the handwheel (18) the saw blade can be steplessly tilted to the right from 0° (vertical) through 45°.

The centre of motion is at saw table level, so the depth of cut remains the same regardless of the bevel angle.

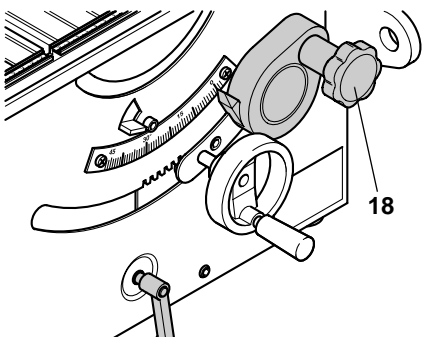

Ratchet lock lever

The set bevel angle can be locked with a ratchet lock lever (19), so it does not change during sawing.

i Note:

There are several ratchet lock levers on the saw. If the swivelling range is not sufficient, the lever position can be shifted:

pull lever up, turn and let engage again.

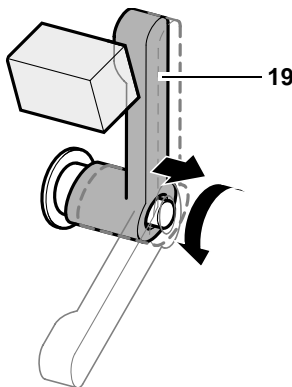

Lever, blade tilt limiter

The blade tilt setting has end stops at 0° and 45°. For special bevel cuts (undercutting) the bevel angle can be increased by 1.5° in both directions.

- Blade tilt limiter (20) left (down) = saw blade bevel angle adjustable between 0° and 45°.
- Blade tilt limiter (20) right (up) = saw blade bevel angle adjustable between -1.5° and 46.5°.

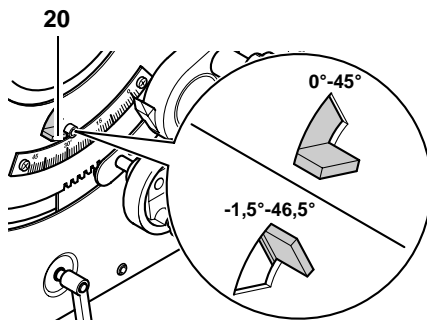

Rip fence

The rip fence (21) slides into the saw table's front extrusion.

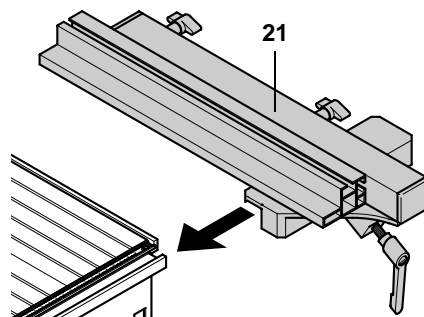

The auxiliary fence extrusion can be taken off and reversed after loosening the two screws (22).

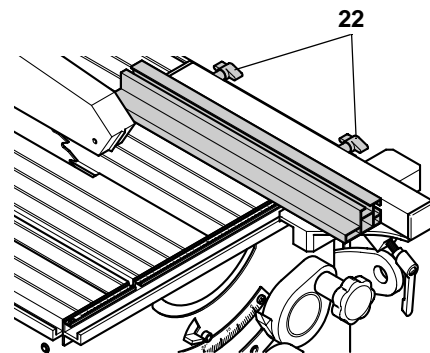

- Wide edge = for cutting thick workpieces (max. 65 mm).
- Small edge =
 - for cutting thin stock;
 - when the saw blade is tilted.

Mitre fence

The mitre fence (23) is inserted into the table slot from the table's front edge.

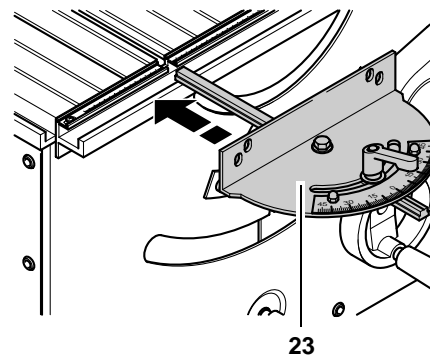

For mitre cuts the mitre fence can be adjusted after loosening the lock lever (24) (±47°).

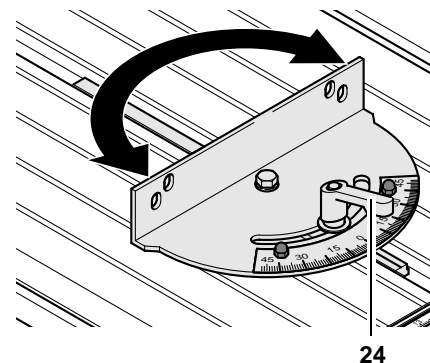

7. Initial Operation

7.1 Installation

There are two ways to ensure a firm stand of the machine:

- Installation on workstand (optional accessory);
- Installation on a solid table or workbench with **solid top**.

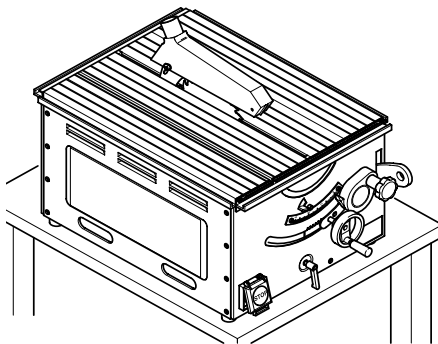

7.2 Riving knife alignment and blade guard installation.

1. Raise saw blade fully.
2. Loosen removable table section (25) and remove from table.

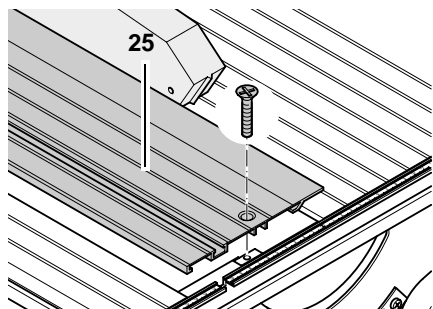

3. Loosen screws (26) of the riving knife bracket.

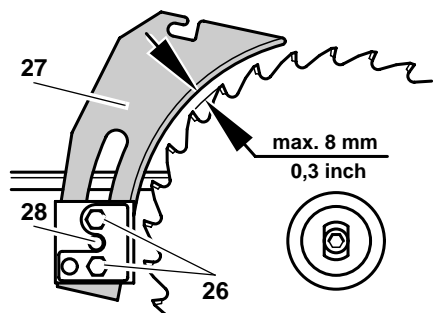

4. Pull riving knife (27) up against the stop.
5. Tighten screws (26) of the riving knife bracket.
6. Loosen hexagon socket head cap screw (28) (to do so, turn hexagon socket head cap screw **counter-clockwise!**) and adjust riving knife position. The distance between the saw blade's outer edge and the riving knife must be 3 – 8 mm.

⚠ Danger!
The riving knife is one of the safety devices and has to be correctly installed for a safe operation.

7. Tighten hexagon socket head cap screw (to do so, turn hexagon socket head cap screw (28) **clockwise!**)
8. Fasten removable table section.
9. Install blade guard (30) on riving knife (29).

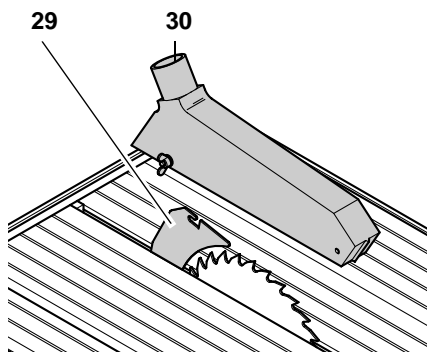

7.3 Connection of dust collector

⚠ Danger!
Dust of certain timber species (e.g. oak and ash) can cause cancer when inhaled: always use a dust collector when working in enclosed spaces (air speed at the saw's dust collection port ≥ 20 m/s).

⚠ Caution!
Operation without a dust collector is only possible:

- outdoors;
- for short-term operation (up to max. 30 minutes);
- with dust respirator.

If no dust collector is used, saw dust and chips accumulate inside the machine housing. These remains have to be removed after 30 minutes at the latest.

Dust collection ports are located on the chip case and blade guard.

- Fit the chip ejection tube (31) onto suction port of saw housing as illustrated.

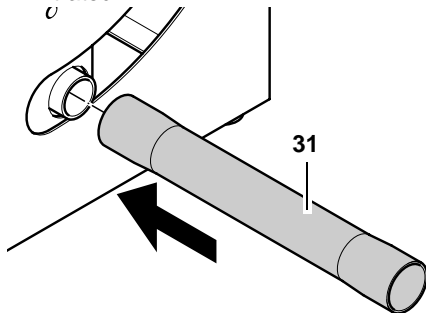

⚠ Danger!
By the revolving motion of the saw blade the saw dust is blown from the chip ejection tube. Watch where the jet of saw dust is aimed at.

⚠ Caution!
In order for the saw dust to be effectively led off, the chip ejection tube supplied has to be installed even if no dust collector is hooked up. The chip ejection tube shall not be blocked by other objects.

7.4 Mains connection

⚠ Danger! Electrical Hazard
Operate saw in dry environment only.

Operate saw only on a power source matching the following requirements (see also "Technical Specifications"):

- mains voltage and system frequency conform to the voltage and frequency shown on the saw's name plate;
- fuse protection by a residual current operated device (RCD) of 30 mA sensitivity;
- outlets properly installed, earthed and tested.

Position power supply cable so it does not interfere with the work and is not damaged.

Protect power supply cable from heat, aggressive liquids and sharp edges.

Use only rubber-jacketed extension cables with sufficient lead cross-section ($3 \times 1.5 \text{ mm}^2$).

Do not pull on power supply cable to unplug.

8. Operation

⚠ Risk of injury!
This saw may only be operated by one person at a time. Other persons may stay only at a distance from the saw for the purpose of feeding or removing stock.

Before starting work check to see that the following are in proper working order:

- power cable and plug;
- ON/OFF switch;
- riving knife;
- blade guard;
- push stick.

Use personal protection gear:

- dust respirator;
- hearing protection;
- safety goggles.

Assume proper operating position:

- at the front of the saw;
- in front of the saw;
- to the left of the line of cut.
- If working with two persons the second person should stand at a rear table extension.

If the type of work requires, use the following:

- table extension (accessory) if working with two persons or if otherwise workpieces would fall off the saw table;
- sliding carriage (accessory);

- dust collector.

Avoid typical operator mistakes:

- Do not attempt to stop the saw blade by pushing the workpiece against its side. Risk of kickback.
- Always hold the workpiece down on the table and do not jam it. Risk of kickback.
- Never cut several workpieces at the same time – and also no bundles containing several individual pieces. Risk of personal injury if individual pieces are caught by the saw blade uncontrolled.



Drawing-in/trapping hazard!
Never cut stock to which ropes, cords, strings, cables or wires are attached or which contain such materials.

8.1 Sawing

For cutting the workpiece is evenly fed against the saw blade towards the rear of the table:

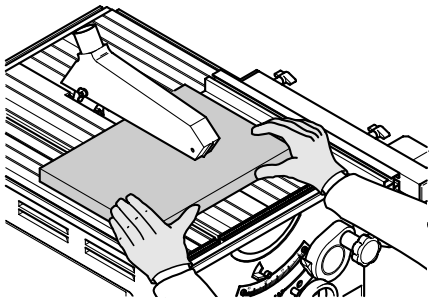

1. Set depth of cut. The blade guard must rest with its front edge on the workpiece.
2. Set blade tilt and lock in position.
3. Mount rip fence, if required.
4. Start saw.
5. Cut workpiece in a single pass.
6. Switch machine off if no further cutting is to be done immediately afterwards.

Mitre cuts

1. Fit mitre fence to the table slot.
2. Loosen ratchet lock lever (32), set fence to desired angle and tighten ratchet lock lever again.
3. Hold workpiece firmly against mitre fence.
4. Cut workpiece by pushing the mitre fence forward.

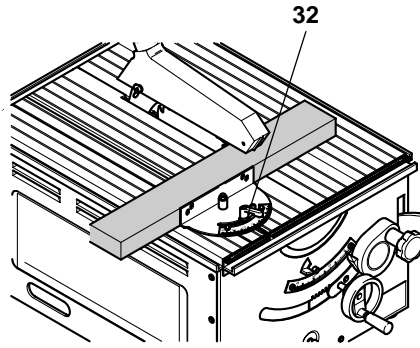

9. Care and Maintenance



Danger!
Prior to all servicing:

- switch machine OFF;
- unplug power cable;
- wait until the saw has come to a complete stop.
- Check that all safety devices are operational again after each service.
- Repair and maintenance work other than described in this section should only be carried out by qualified specialists.

9.1 Saw blade change



Danger!
Risk of injury by cuts from the saw blade's teeth. Wear gloves when changing blades.

1. Remove blade guard.
2. Loosen removable table section (33) and remove from table.

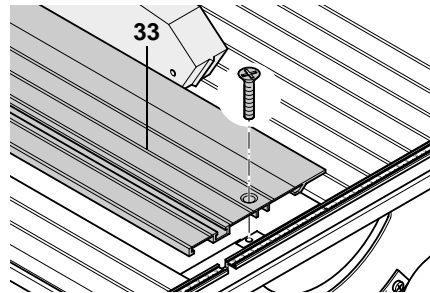

3. Loosen screw fitting (34) at the bottom of the chip case and remove cover plate (35) by pulling it upward.

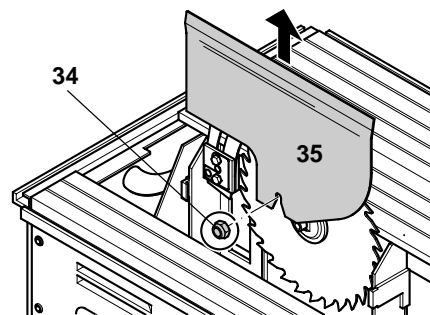

4. Hold saw spindle with 13 mm open jaw wrench and loosen arbor bolt (36) with Allen key (L.H. thread!).

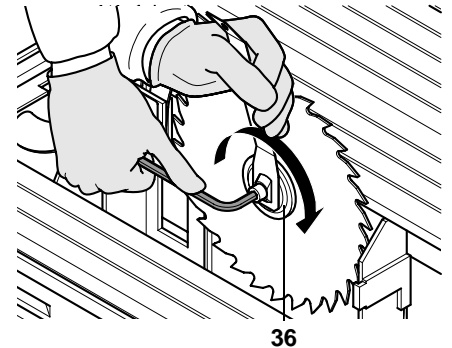

5. Take blade off the saw spindle.
6. Clean clamping surfaces of saw spindle and saw blade.



Danger!
Do not use cleaning agents (e.g. for removing resin residue) that could corrode the light metal components of the saw; the stability of the saw would be adversely affected.

7. Put on a fresh saw blade (observe direction of rotation!).

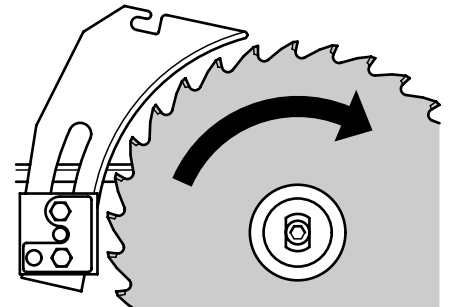

Danger!
Use only suitable saw blades according to EN 847-1 (see "Technical Specifications" – when using unsuitable or damaged blades parts could be explosive-like hurled from it by centrifugal force.

Do not use:

- saw blades which permissible maximum speed is below the rated no-load speed of the saw spindle (see "Technical Specifications");
- saw blades made of high speed steel (HSS);
- saw blades with visible damage;
- cut-off wheel blades.



Danger!
Mount saw blade only using genuine parts.
Do not use loose-fitting reducing rings; the saw blade could work loose.
Saw blades have to be mounted in such way that they do not wobble or run out of balance, and can not work loose during operation.

8. Slide outer blade collar onto blade spindle (observe centring of blade collar).

- Screw in arbor bolt (L.H. thread!) and tighten **fingertight** with the Allen wrench supplied.



Danger!

- Do not extend arbor bolt tightening wrench.
 - Do not tighten arbor bolt by hitting the Allen key.
- Fasten cover plate to chip case.
 - Fasten removable table section.
 - Attach blade guard.

9.2 Scale setting

The scale can be set to correspond with the saw blade thickness:

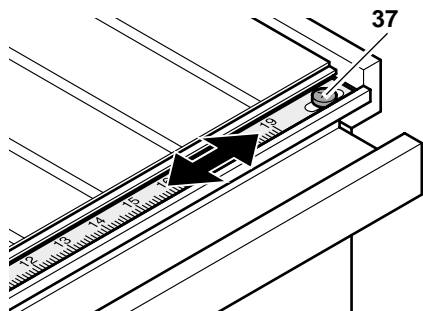

- Loosen fixing screws and adjust scale as required (37).
- Tighten fixing screws and verify setting by making a trial cut.

9.3 Mitre fence adjustment

- Use try square to check if mitre fence is at right angle to the saw blade.
- Loosen fixing screws (38) and adjust graduated arc scale, if necessary.

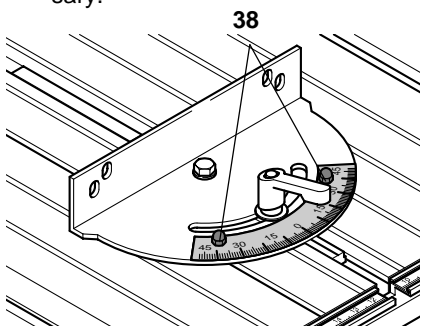

- Tighten fixing screws.

9.4 Blade tilt stop setting

- Set the blade tilt limiter (39) to the left (0° to 45° position).

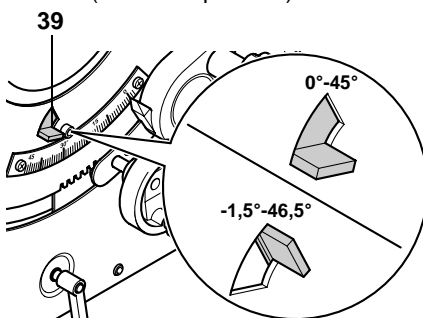

- Check blade bevel angle:
 - 0° = square with the saw table
 - 45° with separate mitre square.
 If these angles are not exactly matched:
- Remove removable table section.
- Adjust setting screws (40) of stops until the blade tilt against the saw table at the end positions is exactly 0° (= square) and 45°, respectively.

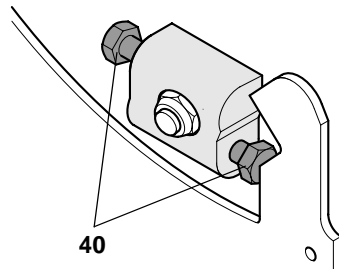

- After adjusting the stops the angle scale at the machine front may need readjustment.
- Fasten removable table section.

9.5 Saw cleaning

- Lay machine on its side.
- Remove chips and saw dust with vacuum cleaner or brush:
 - from saw blade setting guide elements;
 - from motor vent slots.

9.6 Machine storage



Danger!

Store saw so that

- it can not be started by unauthorized persons and
- nobody can get hurt.

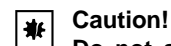

Caution!

Do not store saw unprotected outdoors or in damp environment.



Note:

The ON/OFF buttons can be blocked by a padlock.

9.7 Maintenance

Before switching on

Visual check if distance saw blade – riveting knife is 3...8 mm.

Visual check of power cable and power cable plug for damage; if necessary have damaged parts replaced by a qualified electrician.

Monthly (if used daily)

remove saw dust and chips with vacuum or brush; apply light coat of oil to guide elements:

- threaded rod and guide rods of blade rise and fall mechanism:
- swivel segments.

Every 300 hours of operation

Check all screwed joints, retighten if necessary.

10. Tips and Tricks

- Before cutting a workpiece to size make trial cuts with pieces of scrap.
- Always place a workpiece on the saw table in such way that it can not tilt or rock (e.g. always place a curved board on the table with the convex side up).
- When working long stock use suitable supports, such as table rear or side extensions (optional accessories).
- To simplify repetitive cut-off work use a stock stop (optional accessory).
- Keep surfaces of saw table and saw base clean – in particular, remove resin residue with a suitable cleaning and maintenance spray (optional accessory).

11. Available Accessories

For special tasks the following accessories are available at your specialized dealer – see back cover for illustrations:

- A Workstand**
Provides for a secure machine stand and optimal working height; ideal in mobile use, folds up for saving space.
- B Base System Rail**
Required for the installation of Sliding Carriage, Table Side or Table Rear Extension.
- C Base System Rail Extension**
To extend the Base System Rail to 1350 mm. The enclosed support leg provides for a firm stand.
- D Support leg for Base System Rail Extension**
Provides extra support for the Base System Rail Extension.
- E Sliding Carriage with Mitre Fence**
For installation on the Base System Rail. Capacity before the blade up to 600 mm.
- F Table Side Extension**
For installation on the Base System Rail. Extends the saw table to the left or right.
- G Rear Table Extension with support leg**
For installation on the Base System Rail. Extends the saw table at front and/or rear by 1000 mm.
- H Dust Collection Attachment**
Helps to protect your health and to keep the shop clean.

- I** Suction Adapter
To connect a shop vacuum to the dust collection attachment.
- J** Roller/Ball Transfer Stand
For accurate guiding of long stock.
- K** Care and Maintenance Spray
To remove resin residue and preserve metal surfaces.
- L** TCT Saw Blade
210x2.2/1.4x30 30 ATB
For rip and cross cuts in grown timber and particle board.
- M** TCT Saw Blade
210x2.2/1.4x30 42 ATB
For rip and cross cuts in panels; plastic, aluminium, copper extrusions and high-grade veneered sheets.
- N** TCT Saw Blade
210x2.2/1.4x30 64 ATB
General purpose blade for plastics and metals.

12. Repairs



Danger!

Repairs to electric tools must be carried out by qualified electricians only!

Electric tools in need of repair can be sent to the service centre of your country. Refer to the spare parts list for the address.

Please attach a description of the fault to the electric tool.

13. Environmental Protection

The saw's packaging can be 100% recycled.

Worn out electric tools and accessories contain considerable amounts of valuable raw and plastic materials, which can be recycled.

These instructions are printed on chlorine-free bleached paper.

14. Trouble Shooting



Danger!

Before carrying out any fault service or maintenance work always:

1. **switch machine OFF;**
2. **unplug power cable;**
3. **wait for saw blade to come to standstill.**

Check to see that all safety devices are operational after each fault service.

Motor does not run

Undervoltage relay tripped by power failure:

- switch on again.

No mains voltage:

- check cables, plug, outlet and mains fuse.

Motor overheated, e.g. by a blunt saw blade or chip build-up in the chip case:

- eliminate cause for overheating, wait for a few minutes, then start saw again.

Stated top speed is not reached

Motor supply voltage too low:

- use a shorter extension cable or extension cable with larger lead cross section ($\geq 1.5 \text{ mm}^2$).
- Have power supply checked by a qualified electrician.

Loss of cutting performance

Saw blade blunt (possibly tempering marks on blade body):

- replace saw blade (see section "Maintenance").

Chip ejection tube blocked

No dust collector hooked up or suction capacity insufficient:

- connect dust collector or
- increase suction capacity (air speed $\geq 20 \text{ m/sec}$ at chip ejection tube).

15. Technical Specifications

Voltage		V	230 (1~ 50 Hz)
Wattage	power input P ₁	kW	1.8 S6 40%
	power output P ₂	kW	1.1 S6 40%
Current draw		A	8.8
Fuse protection min.		A	10 (time-lag or K-Automat)
Degree of protection			IP 20
Rated no-load speed (at 230V)		min ⁻¹	4500 ± 10%
Cutting speed (at 230V)		m/s	49.5 ± 10%
Saw blade diameter (outer)		mm	210
Saw blade arbor bore diameter (inner)		mm	30
Kerf width		mm	2.5
Depth of cut	with saw blade vertical at 45 ° saw blade tilt	mm	0 ... 65
		mm	0 ... 45
Dimensions	length of saw table	mm	540
	width of saw table	mm	430
	height (with blade guard)	mm	505
Machine weight		kg	23.5
Noise emission value, idle running dust collection disabled.			
	Sound pressure level A L _{pA}	dB (A)	85.5
	Sound power level A L _{WA}	dB (A)	97.0
Noise emission value during sawing operation, dust collection on			
	Sound pressure level A L _{pA}	dB (A)	88.3
	Sound power level A L _{WA}	dB (A)	100.0

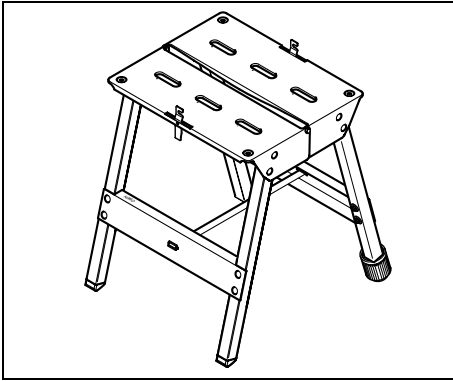

A 091 001 7047

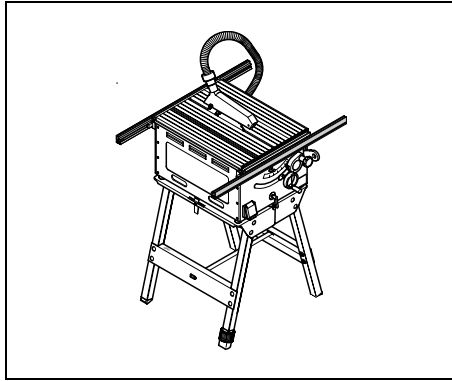

B 091 001 8450

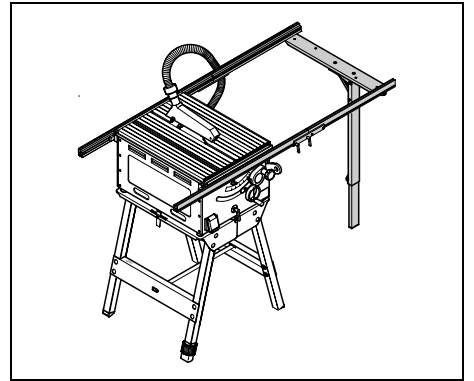

C 091 005 0028

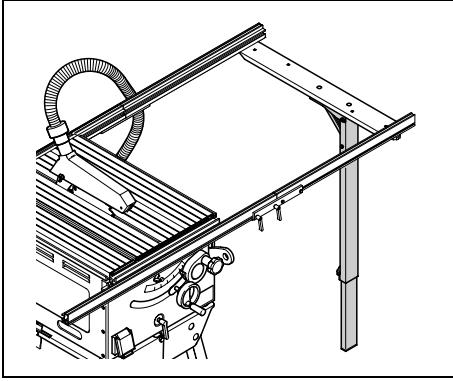

D 091 005 0036

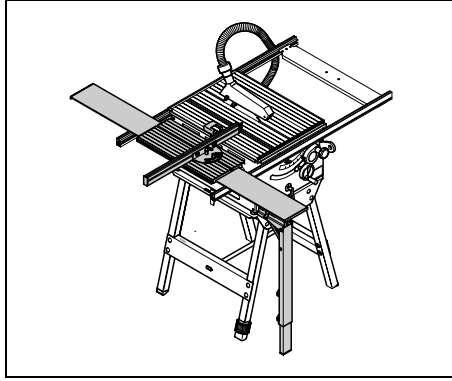

E 091 001 8434

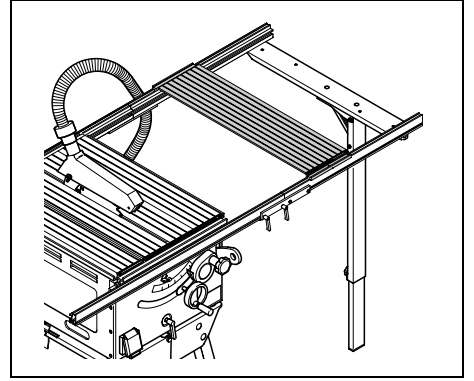

F 091 001 8442

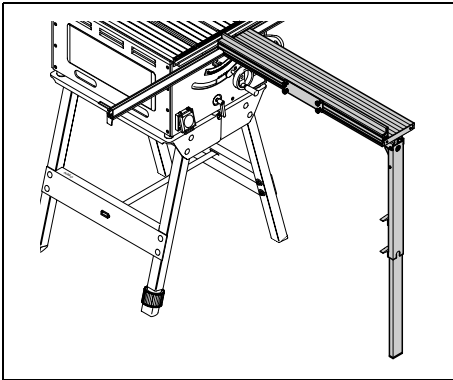

G 091 001 8469

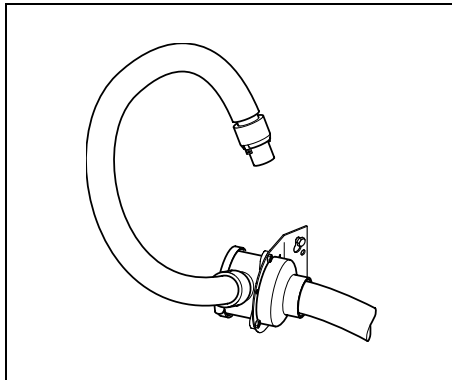

H 091 001 7608

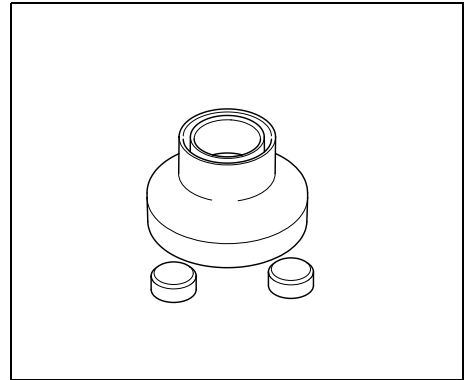

I 091 003 1260

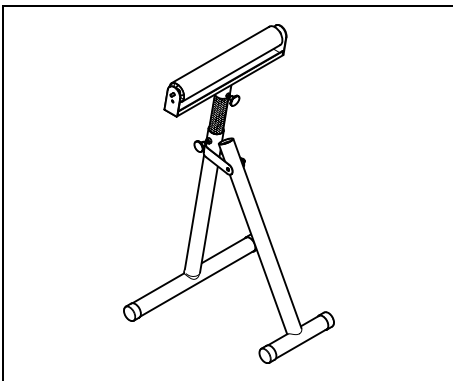

J 091 005 3353

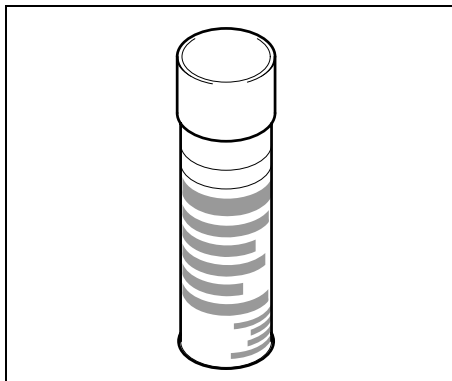

K 091 101 8691



210x2,2/1,4x30 30WZ

L 091 001 8965



210x2,2/1,4x30 42WZ

M 091 001 8973



210x2,2/1,4x30 64WZ

N 091 001 8981